

☐ WEST MAIN STREET / HIGHWAY M-43
(MDOT JURISDICTION, 120' WIDE PUBLIC RIGHT OF WAY)

PROPOSED NORTH ELEVATION
SCALE: 1/4"=1'-0"

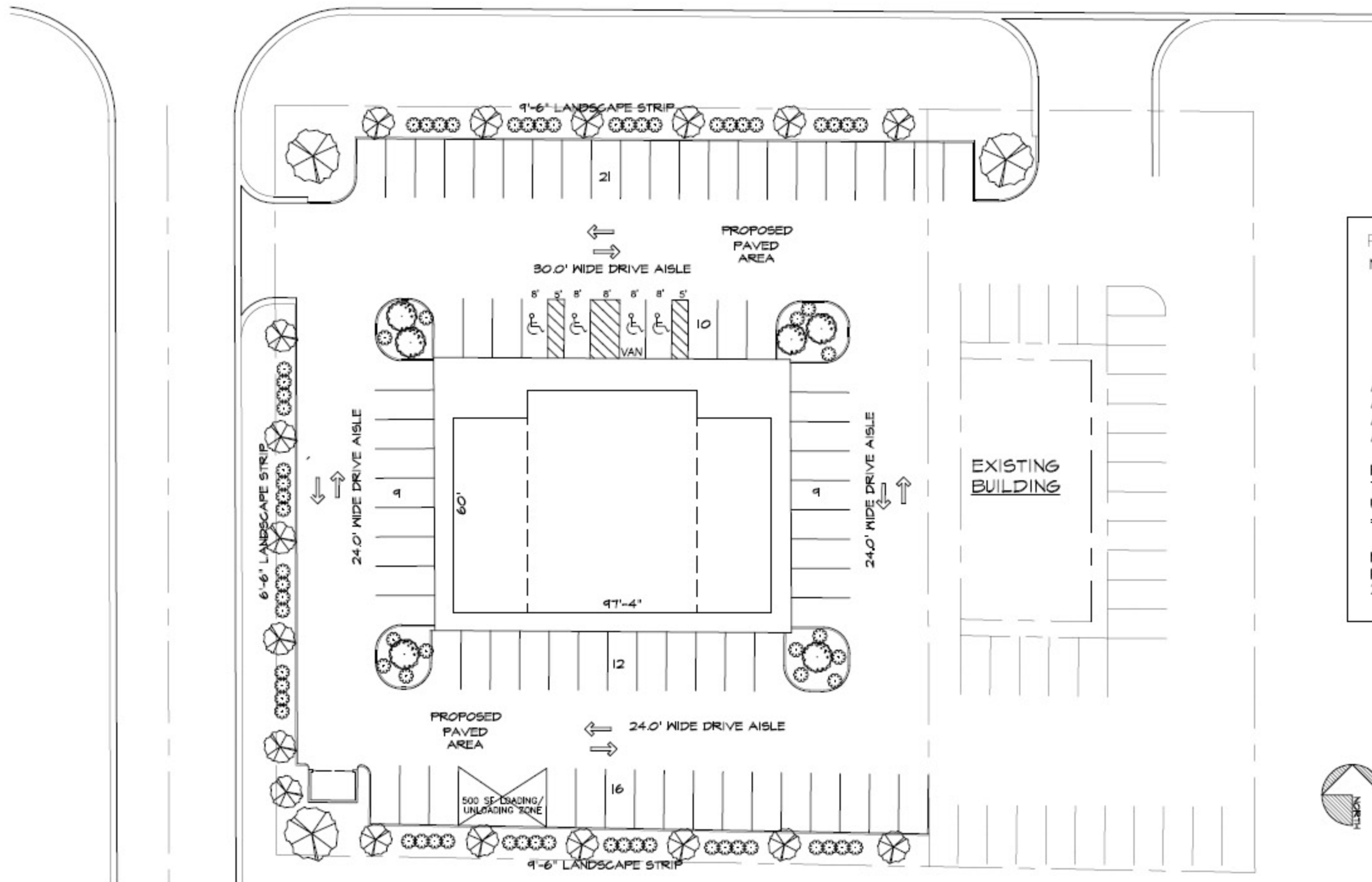

PARKING SPACE DATA:
NUMBER OF PARKING SPACES ON SUBJECT PROPERTY
STANDARD PARKING SPACES = 73
BARRIER FREE SPACES = 4
TOTAL # SPACES ON-SITE = 77

ALL STANDARD PARKING SPACES MEASURE 9.0' x 18.0'
ALL BARRIER FREE SPACES MEASURE 8.0' x 18.0'
AISLE WIDTH FOR A VAN BARRIER FREE SPACE = 8.0'
AISLE WIDTH FOR A REGULAR BARRIER FREE SPACE = 5.0'

REQUIRED PARKING DATA:
TOTAL AREA BLDG = 6,269 SQ.FT.
USEABLE FLOOR AREA = 6,269 x 80% = 5,015 SQ.FT.
= 5,015 SQ.FT. / 100 = 50 PARKING SPACES

MINIMUM REQUIRED # PARKING SPACES = 50
PARKING EASEMENT WITH PROPERTY TO THE EAST FOR 25 PARKING SPACES

SITE PLAN
SCALE: 1"=20'-0"

PROPOSED REDEVELOPMENT FOR:
MEYER C. WEINER
4315 WEST MAIN ST. (M-43)
KALAMAZOO, MICHIGAN

8120 MOOREBRIDGE RD.
PORTAGE, MI 49782
PHONE 269.323.3500
FAX 269.323.3768
DESIGN CM BLD



REVISIONS:

DATE: 4.18.07
PROJECT: 0745

S1